

since 1988



the sound

HIGH-PERFORMANCE CAR-AMPLIFIER

OWNER'S MANUAL

H SERIES
BY AUDIO SYSTEM



H-3000.1 D

H-4500.1 D

CE

Congratulation on your purchase of your new **H SERIES** amplifier.

IMPORTANT: Before installation your power amplifier, we recommend to read the owner's manual carefully and to follow the instructions regarding connection and fitting exactly.

ATTENTION: Pay attention to advices and instructions of the car manufacturer.

IMPORTANT: Your proof of purchase is evidence of warranty claim for repair or replacement. Keep your proof of purchase, manual and original packaging.

ATTENTION: Use of sound components can impair your ability to hear necessary traffic sounds and may constitute a hazard while driving your automobile.

AUDIO SYSTEMGERMANY accepts no liability for hearing loss, bodily injury or property damage as a result of use or misuse of our products.

We recommend installing the equipment by an authorized service center or dealer. A professional fitting and connection is the requirement for further warranty and perfect sound.

H-3000.1 D

- 1-Channel digital Mono-High-Power amplifier
- High efficiency of max. 86 %
- Stable into 1 Ohm mono
- Variable Low Pass Filter from 35 to 300 Hz with 24 dB / oct
- Variable Subsonicfilter from 10 to 60 Hz
- Variable Phase Shift from 0° to 180°
- Variable Bass-Boost from 0 - 12 dB @ 45 Hz
- Input Sensitivity from 0,2 to 6 V
- Multi-Way Protection Circuitry: overheating, overcurrent, short circuitry and speaker DC protection
- Operation Voltage from 10 to 16 V
- Wired Remote Controller **RTC**
- Longlife double sided Epoxy PC Board and high quality RCA Connector
- Wire size up to 50mm² possible
- 2x **H-3000.1 D** linkable to 7500 Watt RMS Max-Power - **NO WARRANTY!**



H-4500.1 D

- 1-Channel digital Mono-High-Power amplifier
- High efficiency of max. 87 %
- Stable into 1 Ohm mono
- Variable Low Pass Filter from 35 to 300 Hz with 24 dB / oct
- Variable Subsonicfilter from 10 to 60 Hz
- Variable Phase Shift from 0° to 180°
- Variable Bass-Boost from 0 - 12 dB @ 45 Hz
- Input Sensitivity from 0,2 to 6 V
- Multi-Way Protection Circuitry: overheating, overcurrent, short circuitry and speaker DC protection
- Operation Voltage from 10 to 16 V
- Wired Remote Controller **RTC**
- Longlife double sided Epoxy PC Board and high quality RCA Connector
- Wire size up to 50mm² possible
- 2x **H-4500.1 D** linkable to 10000 Watt RMS Max-Power - **NO WARRANTY!**

H-3000.1 D/ H-4500.1 D

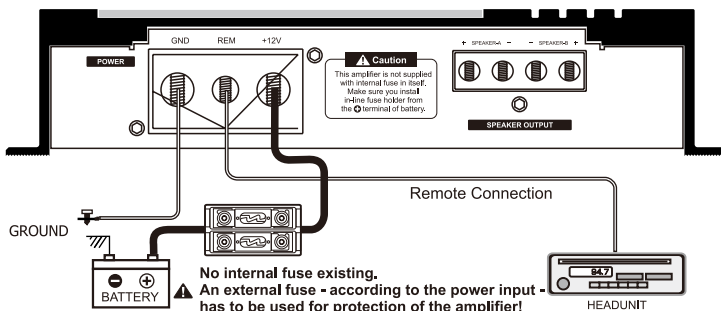
**1. Battery disconnection:**

First, disconnect the power supply of the vehicle by removing the ground cable of the battery.

2. Ground connection:

Connect the GND (ground) connection of the amplifier with the car chassis. Keep this cable as short as possible (not longer than 50 cm) and use a suitable cross section (AWG size 7-5). Make sure, that the connection with the vehicle chassis is free of paint, dirt and dust.

3. +12 V Power connection:

Connect the +12 V contact of the amplifier with the supply cable via a fuse directly to the vehicle battery. Keep in mind, that the length of the cable from fuseholder to vehicle battery has to be maximum 30cm. For the amplifier to function at its best, use a high quality fuse holder and suitable cable preferably AWG 7-5 cable. This fuse protects the amplifier and the vehicle against the possibility of a short circuit in the power cable.

4. Remote connection:

Connect the REM-terminal of the amplifier to the remote-output (automatic 12 V antenna-output) of the head unit. Use a 0,5 - 1,5 mm power cable.

**ATTENTION**

Please follow the instructions during the installation of your amplifier:

- a) Take care of a professional attachment. Pay attention, that no electrical cable, gas tank, hydraulic breakers or other components get damaged.
- b) There has to be enough cooling and air circulation. Avoid the installation in small closed boxes or close to heating parts.
- c) Protect the amplifier from fluids, wetness, heat and foreign material as well as from other influences.
- d) The amplifier is only to be built into vehicles with a 12 V DC power supply.
- e) Never install the power supply cable with other original wires of the vehicle (gas cables), fan motors, brand control moduls etc.
- f) Install the signal cable (cinch cable) as well as the speaker cable far away of the power cables to avoid troubles with the music signal.
- g) The cables of your amplifier have to be installed, so that there is no danger of binding, squeezing or breaking.

H-3000.1 D / H-4500.1 D

1. RCA connection for operation of one amplifier

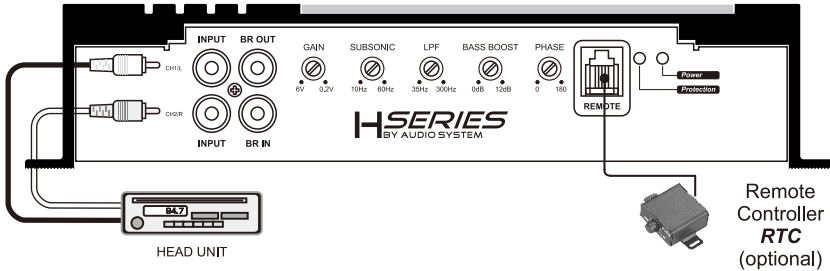

2. RCA connection for operation of two amplifier in LINK-MODUS

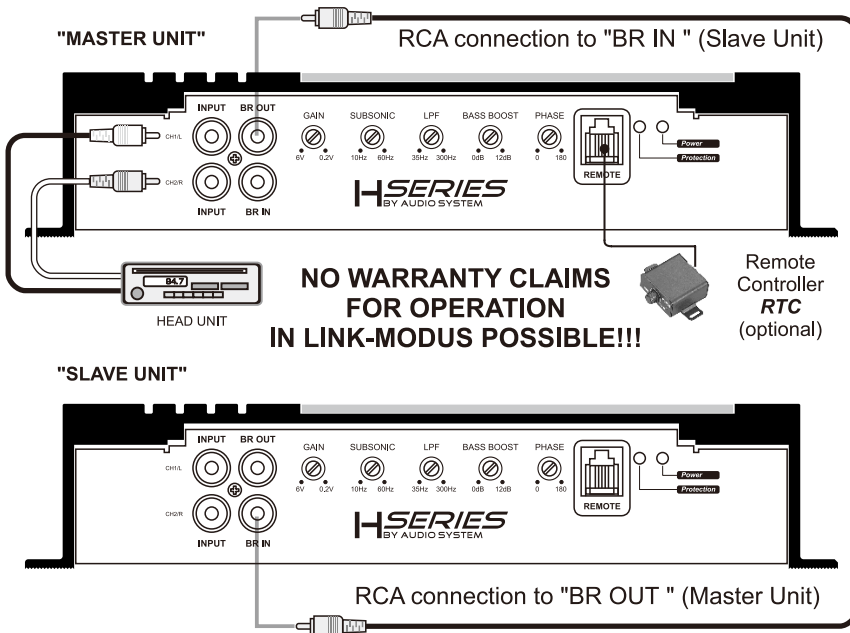

The H SERIES amplifier offers RCA-Inputs, which are connected through cinch cables with the preamplifier-outputs of the head unit. At the „BR OUT“-RCA it's possible create a Master-Slave-Modus with a second H-3000.1 D or a second H-4500.1 D.

No warranty claims for operation in LINK-MODUS possible.

With the aid of the variable subsonicfilter, lowpassfilter, phase shift-controller, bass boost and the gain-controller you are able to adjust the amplifier on to your preferred taste of hearing, the circumstances of the vehicle and to the speakers.

Optional a wire remote controller RTC can be installed to adjust the output level.

In this regard, **AUDIO SYSTEM GERMANY** recommends to adjust your amplifier through a specialized service center, dealer or a specialist.

H-3000.1 D / H-4500.1 D

1. Mono

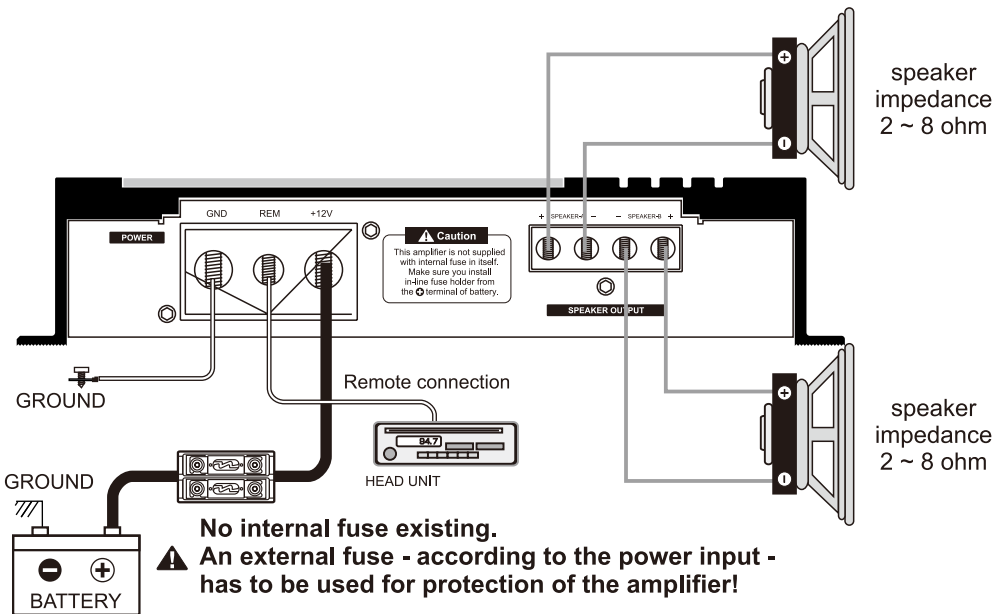
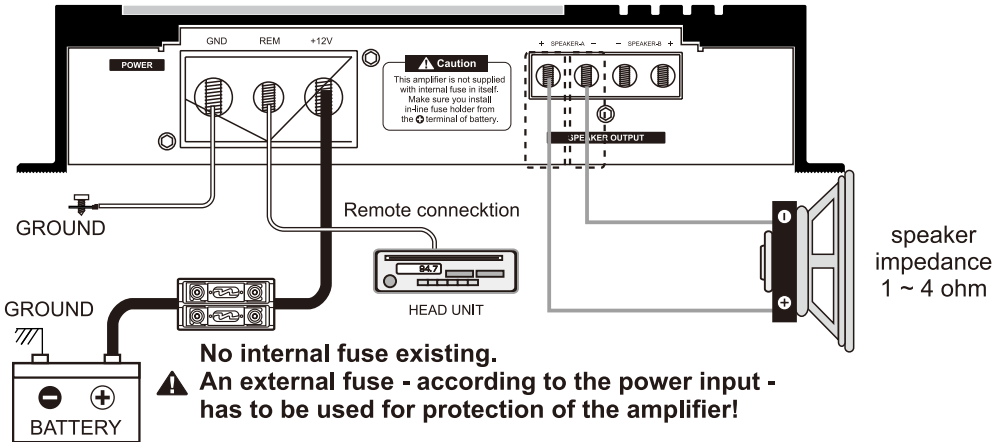

Please note that the H-3000.1 D + H-4500.1 D are pure mono amplifier. When connecting 2 speakers or a dual voice coil subwoofer, the speakers (voice coils) are connected in parallel. It should be noted that each coil has not less than 2 ohms. The total impedance is then 1 ohm.

H-3000.1 D / H-4500.1 D

2. Double Mono Operation / LINK-MODUS

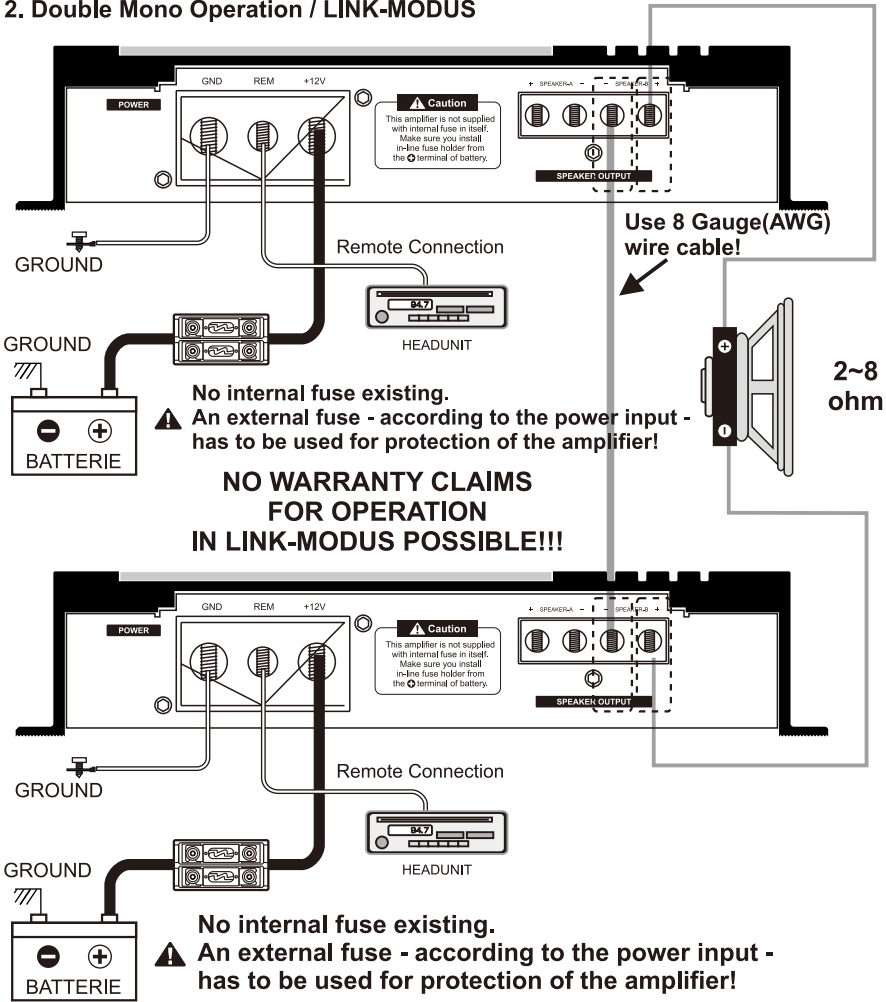

In a dual-mono operation of 2 X H-3000.1 D / 2 X H-4500.1 D assumes the "master amplifier 'total control of the" slave power amp ". The positive (+) terminal of the subwoofer must be connected to the positive terminal of the "Master amplifier". The negative (-) terminal of the woofer to the positive (+) of the "slave power amp". When dual-mono operation of two H-3000.1 D / H-4500.1 D amplifiers, immense power is produced. Please make sure that the connected speakers are suitable for this.

⚠ Achtung

In strapped mode, the total impedance must be at least 2 ohms. Any impedance less than 2 ohms can possibly damage your amplifiers.

NO WARRANTY CLAIMS FOR OPERATION IN LINK-MODUS POSSIBLE!!!

This power amplifier is featured with an efficient protection system to prevent any damages like over-heating, overvoltage, short-circuit and DC at the loudspeaker output. Occuring an error the protection-LED will light in red.

In order to check the problem, first turn down all levels of the head unit, afterwards turn it off.

AMPLIFIER IS NOT POWERED UP, NO LED IS LIGHTENING	<ul style="list-style-type: none"> - ground connection professional connected? - +12V powercable professional connected? - remote cable professional connected? - fuses inserted and alright? - analyze voltage on the amplifier.
PROTECTION LED ILLUMINATES GREEN WHILE AMPLIFIER IS SOUNDLESS	<ul style="list-style-type: none"> - cinch cable alright and professional connected? - loudspeaker professional connected? - head unit alright?
PROTECTION LED ILLUMINATES RED WHEN AMPLIFIER IS POWERED UP	<ul style="list-style-type: none"> - amplifier too hot? - short-circuit at the loudspeaker output? - short-circuit caused by loudspeaker cable with vehicle chassis (ground)? - input voltage too high (e.g.faulty generator)?
OVERHEATING (PROTECTION LED ILLUMINATES RED WHEN AMPLIFIER IS POWERED UP)	<ul style="list-style-type: none"> - impedance alright? - loudspeaker error? - adequate airflow of the amplifier? <p style="text-align: center;">! CAUTION !</p> <p>After cooling down, the amplifier turns on</p>
ERROR IN AMPLIFIER FUSE	<ul style="list-style-type: none"> - ground professional connected? - loudspeaker impedance alright? <p style="text-align: center;">! CAUTION !</p> <p>Make sure when changing fuses to use the same value.</p>
SOUND TOO LOW OR LOW-DISTORTED SOUND	<ul style="list-style-type: none"> - input level control "GAIN" is set to match the head unit? - output level control of the head unit alright? - loudspeaker error? - loudspeaker cable checked? - crossover frequencies has been properly set? (Check head unit, ampliflier, DSP, soundprozessor, equalizer,
HIGH HISS-ENGINE NOISE IN SPEAKERS	<ul style="list-style-type: none"> - ground connection professional connected? - short-circuit caused by loudspeaker cable with vehicle chassi (ground)? - cinchcable (RCA) and/or loudspeaker cabel installed too close to the power connection cable? - cinch ground (RCA) of the head unit alright?

⚠ ATTENTION ⚠

Please contact your specialized dealer if the amplifier is still not working after it has been checked with the error list!

For warranty adjustement / repairs the original invoice has to be attached!

Opening the power amplifier is leading to a lost of warranty in either case!

H-3000.1 D

Betriebsspannung	10 - 16 V
Ausgangsleistung bei 14,4 V	
-RMS power @ 2 ohm linkbar/Dual-Mono	1x 7500 W
-RMS power@ 1 ohm Mono	1x 3000 W
-RMS power @ 2 ohm Mono	1x 1800 W
-RMS power @ 4 ohm Mono	1x 950 W
Signal to Noise Ratio	>95 dB
Low pass filter	35 ~ 300 Hz
Subsonic filter	10 ~ 600 Hz
Bass boost @ 45Hz	0 ~ 12 dB
Phase shift control	0 ~ 180°
Frequency response	20 Hz ~ 220 Hz (+/- 1 dB)
T.H.D @ 4 ohm	< 0,1%
Efficiency @ 4 ohms	86 %
Fuse rating	external fuse
Input sensitivity	200 mV ~ 6 V (+/- 5%)
Dimensions	594(W) x 50(H) x 248(L) mm

**H-4500.1 D**

Betriebsspannung	10 - 16 V
Ausgangsleistung bei 14,4 V	
-RMS power @ 2 ohm linkbar/Dual-Mono	1x 10000 W
-RMS power@ 1 ohm Mono	1x 4500 W
-RMS power @ 2 ohm Mono	1x 2600 W
-RMS power @ 4 ohm Mono	1x 1350 W
Signal to Noise Ratio	>94 dB
Low pass filter	35 ~ 300 Hz
Subsonic filter	10 ~ 600 Hz
Bass boost @ 45Hz	0 ~ 12 dB
Phase shift control	0 ~ 180°
Frequency response	20 Hz ~ 220 Hz (+/- 1 dB)
T.H.D @ 4 ohm	< 0,1%
Efficiency @ 4 ohms	87 %
Fuse rating	external fuse
Input sensitivity	200 mV ~ 6 V (+/- 5%)
Dimensions	594(W) x 50(H) x 248(L) mm